

LED UK

Sirius

The Sirius LED is a 183mm diameter downlight which utilises a CREE XP-E LED Array. The heatsink is constructed from die-cast aluminium complete with aluminium bezel and reflector. The heatsink features adjustable fold-out arms which allows the Sirius to be installed with ease. The downlight is available in outputs from 2000lm to 3500lm and as standard is rated IP65.

- CREE XP-E LED Array
- Cast Aluminium
- Instant on - no flicker
- Environmentally Friendly - No mercury or lead enters the environment
- No RF and electronic magnetic interference
- Over 50,000 hours life span
- Rated IP65



General

Dimensions	Ø183 x 80mm
Cutout	Ø160-175mm
Weight	1.1kg
Beam Angle	90°
Installation	Ceiling Tile Plasterboard
Voltage	220-240Vac
Certification	CE, ROHS
Warranty	5 Years
IP Rating	IP65

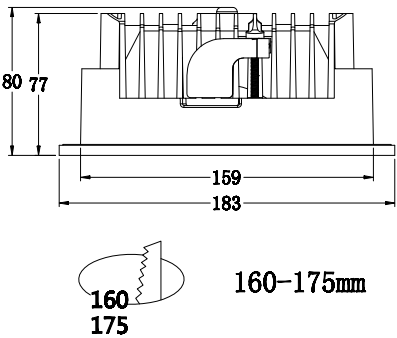

Performance

Colour Rendering	Ra>85
UGR	<19
MacAdam Ellipse	3 Step
System Power	20 W 30 W 40W
Exit Lumens	2000 Lm 3000 Lm 4000 Lm
Efficiency	105.57 lm/W 107.96 lm/W 107.12 lm/W
Longevity	L80 / B20 @ 50,000 hours
Compliance	Building Regulations ETL (Energy Technology List) ECA (Enhanced Capital Allowance) SKA Rating

Available options

Wattage	20W - 2000 lm, 30W - 2600 lm, 40W - 3500 lm
Colour	White, Special RAL Colour
Colour Temperature	3000K, 4000K, 5000K
Lens	Frosted Diffuser
Dimming	Fixed Output, 1-10V Dimming , DALI Dimmable, Mains Dimming, Switch Dimming
Emergency	Not Required, 3 Hour Facility, 3 Hour Self Test, 3 Hour Central Test, Central Battery System

Product Code: SRS-S