

LED UK

Sirius Nano

The Sirius Nano LED is a 103mm diameter downlight which utilises CREE-XP-E LED Array. The heatsink is constructed from die-cast aluminium and is complete with an aluminium bezel and reflector. The heatsink features fold-out arms which allows the Sirius Nano to be installed with ease. The downlight is available in 780 Lumens and as standard is rated IP65.

- CREE XP-E LED Array
- Cast Aluminium
- Instant on - no flicker
- Environmentally Friendly - No mercury or lead enters the environment
- No RF and electronic magnetic interference
- Over 50,000 hours life span
- Rated IP65



General

Dimensions	Ø103 x 58mm
Cutout	Ø90mm
Weight	0.7kg
Beam Angle	90°
Installation	Ceiling Tile Plasterboard
Voltage	220-240Vac
Certification	CE, ROHS
Warranty	5 Years
IP Rating	IP65

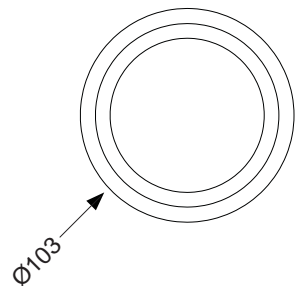
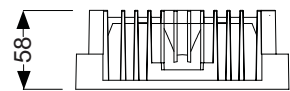

Performance

Colour Rendering	Ra>85
UGR	<19
MacAdam Ellipse	3 Step
System Power	9 W
Exit Lumens	810 lm
Efficiency	96.65 lm/W
Longevity	L80 / B20 @ 50,000 hours
Compliance	Building Regulations ETL (Energy Technology List) ECA (Enhanced Capital Allowance) SKA Rating

LED UK

Sirius Nano

Available options

Wattage	9W - 780 Lm
Colour	White, Special RAL Colour
Colour Temperature	3000K, 4000K, 5000K
Lens	Frosted Lens
Dimming	Fixed Output, 1-10V Dimming, DALI Dimming, Mains Dimming, Switch Dimming
Emergency	Not required, 3 Hour Facility, 3 Hour Self Test, 3 Hour Central Test, Central Battery System

Product Code: SRS-N