

LED UK

Sirius Mini Clear

The Sirius Mini Clear LED is a 144mm diameter downlight which utilises a CREE XP-E LED Array. The heatsink is constructed from die-cast aluminium complete with aluminium bezel and reflector. The heatsink features fold-out arms which allows the Sirius Mini to be installed with ease. The downlight is available in 1550 & 1850 Lumens and as standard is rated IP65.

- CREE XP-E LED Array
- Cast Aluminium
- Instant on - no flicker
- Environmentally Friendly - No mercury or lead enters the environment
- No RF and electronic magnetic interference
- Over 50,000 hours life span



General

Dimensions	Ø144 x 71mm
Cutout	Ø125mm
Weight	0.9kg
Beam Angle	60°
Installation	Ceiling Tile Plasterboard
Voltage	220-240Vac
Certification	CE, ROHS
Warranty	5 Years
IP Rating	IP65

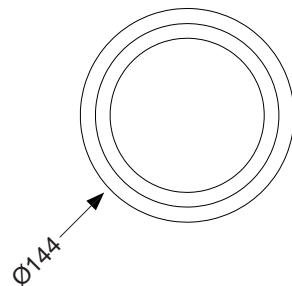
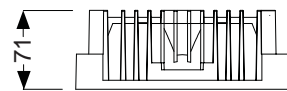

Performance

Colour Rendering	Ra>85
UGR	<19
MacAdam Ellipse	3 Step
System Power	15 W
	20 W
Exit Lumens	1200 Lm
	1600 Lm
Efficiency	82.63 lm/W
	72.81 lm/W
Longevity	L80 / B20 @ 50,000 hours
Compliance	Building Regulations ETL (Energy Technology List) ECA (Enhanced Capital Allowance) SKA Rating

LED UK

Sirius Mini Clear

Available options

Wattage	15W - 1550 lm, 20W - 1850 lm
Colour	White, Special RAL Colour
Colour Temperature	3000K, 4000K, 5000K
Lens	Clear Diffuser
Dimming	Fixed Output, 1-10V Dimming , DALI Dimmable, Mains Dimming, Switch Dimming
Emergency	Not Required, 3 Hour Facility, 3 Hour Self Test, 3 Hour Central Test

Product Code: SRS-M