

LED UK

Trio 500mm Straight Segment

TrioTruss Frame for hanging Lighting or screens from. Modular in construction so can fit your requirements, please contact us with your requirements,

Loading Tables

	2m	4m	6m
Distrib. Load [kg/m]	750	195	29
Deflection [mm]	4.8	12.6	16.8
Point load [kg]	600	415	
Deflection [mm]	2.9	10.5	

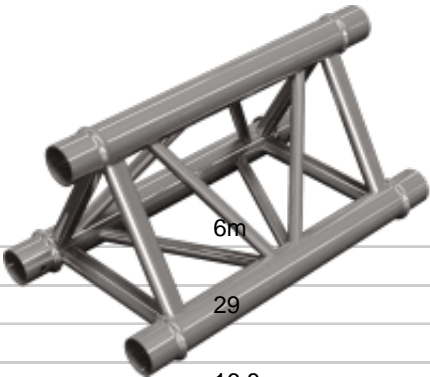

	6.56ft	13.12ft	19.68ft
Distrib. Load [lb/ft]	503	111	1.1
Deflection [inch]	0.2	0.5	0.7
Point load [lb]	1322.8	915	
Deflection [inch]	0.1	0.4	

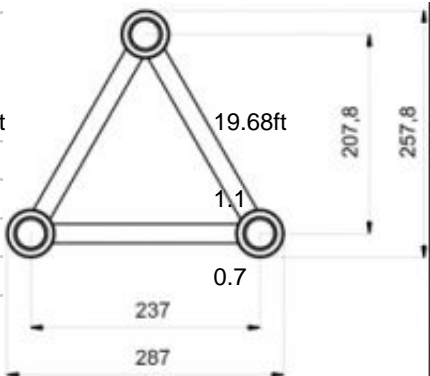

Length	0.5m (1.64 ft)
Weight	2.4 kg (5.29lbs)
Tubes	50x2mm (2 x 0.08inch)
Braces	20x2mm (0.8 x 0.08inch)
Alloy	EN-AW 6082 T6

Product Code: Trio 500mm Straight Segment