

# LED UK

## Trio 2000 mm Straight Segment

Trio Truss Frame for hanging Lighting or screens from. Modular in construction so can fit your requirements, please contact us with your requirements,

### Loading Tables

	2m	4m	6m
Distrib. Load [kg/m]	750	195	
Deflection [mm]	4.8	12.6	29
Point load [kg]	600	415	
Deflection [mm]	2.9	10.5	

	6.56ft	13.12ft	19.68ft
Distrib. Load [lb/ft]	503	111	
Deflection [inch]	0.2	0.5	1.1
Point load [lb]	1322.8	915	
Deflection [inch]	0.1	0.4	

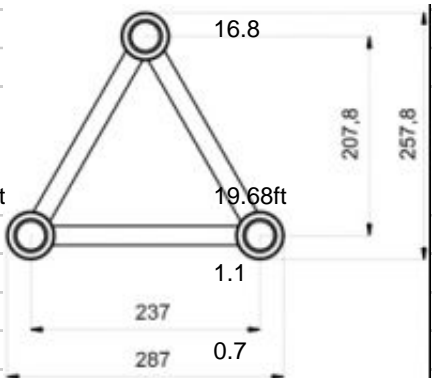
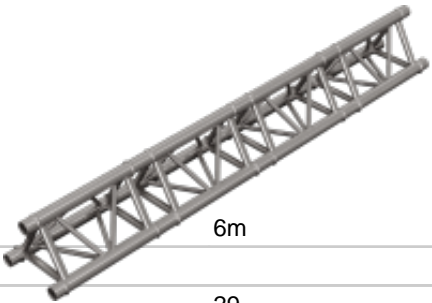

Length	2m (6.56 ft)
Weight	7.5kg (16.53lbs)
Tubes	50x2mm (2 x 0.08inch)
Braces	20x2mm (0.8 x 0.08inch)
Alloy	EN-AW 6082 T6

**Product Code: Trio 2000 mm Straight Segment**