

# LED UK

## Sirius Max Clear

The Sirius Max Clear LED is a 226mm diameter downlight which utilises a CREE XP-E LED Array. The heatsink is constructed from die-cast aluminium complete with aluminium bezel and reflector. The heatsink features adjustable fold-out arms which allows the Sirius to be installed with ease. The downlight is available in outputs from 2550lm to 4250lm and as standard is rated IP65.

- SAMSUNG SMD LED
- Cast Aluminium
- Instant on - no flicker
- Environmentally Friendly - No mercury or lead enters the environment
- No RF and electronic magnetic interference
- Over 50,000 hours life span
- Rated IP65



### General

Dimensions	Ø226 x 96mm
Cutout	Ø200mm
Weight	1.3kg
Beam Angle	90°
Installation	Ceiling Tile Plasterboard
Voltage	220-240Vac
Certification	CE, ROHS
Warranty	5 Years
IP Rating	IP65

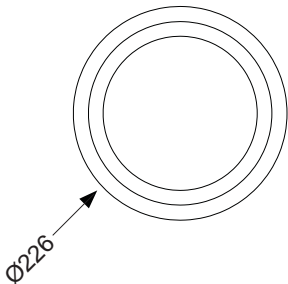
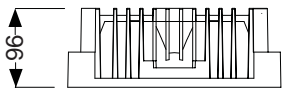

### Performance

Colour Rendering	Ra>85
UGR	<19
MacAdam Ellipse	3 Step
System Power	30 W
	40 W
	50W
Exit Lumens	2400 Lm
	3400 Lm
	4250 Lm
Efficiency	81.77 lm/W
	87.12 lm/W
	82.43 lm/W
Longevity	L80 / B20 @ 50,000 hours
Compliance	Building Regulations ETL (Energy Technology List) ECA (Enhanced Capital Allowance) SKA Rating

# LED UK

## Sirius Max Clear

---

### Available options

Wattage	30W - 2550 lm, 40W - 3400 lm, 50W - 4250 lm
Colour	White, Special RAL Colour
Colour Temperature	3000K, 4000K, 5000K
Lens	Clear Diffuser
Dimming	Fixed Output, 1-10V Dimming , DALI Dimmable, Mains Dimming, Switch Dimming
Emergency	Not Required, 3 Hour Facility, 3 Hour Self Test, 3 Hour Central Test, Central Battery System

Product Code: SRS-X