

LED UK

Quad 1000mm Straight Segment

Quad Truss Frame for hanging Lighting or screens from. Modular in construction so can fit your requirements, please contact us with your requirements.

Loading Tables

	2m	4m	6m
Distrib. Load [kg/m]	1304	438	
Deflection [mm]	5.4	16.2	33.9
Point load [kg]	2080	1000	
Deflection [mm]	5.3	13.3	28

	6.56ft	13.12ft	
Distrib. Load [lb/ft]	876	294.3	
Deflection [inch]	0.2	0.6	
Point load [lb]	4584	2204	
Deflection [inch]	0.2	0.5	

Length	1m (3.28ft)
Weight	5.6kg (12.35lbs)
Tubes	50x2mm (2 x 0.08inch)
Braces	20x2mm (0.8 x 0.08inch)
Alloy	EN-AW 6082 T6

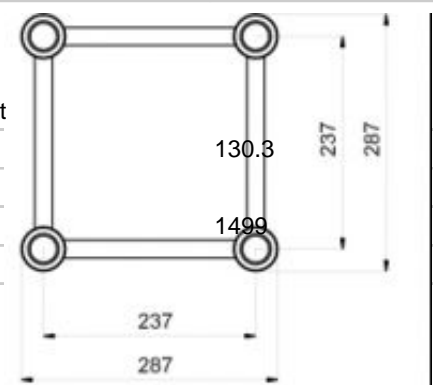
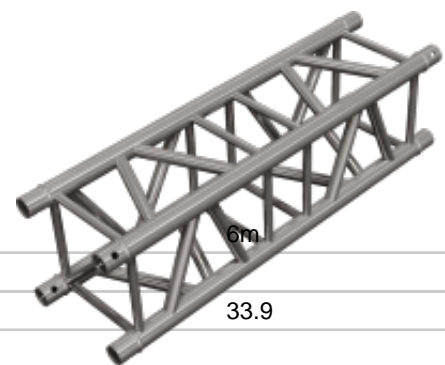

Product Code: Quad 1000mm Straight Segment