

LED UK

Draco Max

The Draco Max LED is a 226mm diameter downlight which uses a Cree XP-E LED Array. The heatsink is constructed from die-cast aluminium complete with aluminium bezel and polished reflector. The downlight is available in outputs from 2550lm to 4250lm and as standard is rated IP20.

- CREE LED Engine
- Cast Aluminium
- Instant on - no flicker
- Environmentally Friendly - No mercury or lead enters the environment
- No RF and electronic magnetic interference
- Over 50,000 hours life span



General

Dimensions	Ø226 x 93mm
Cutout	Ø200mm
Installation	Ceiling Tile Plasterboard
Beam Angle	30° / 45° / 80°
Voltage	AC220-240V
Certification	CE, ROHS
Warranty	5 Years

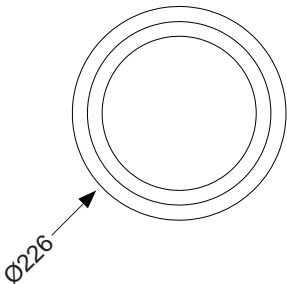
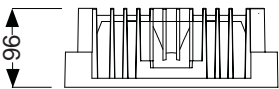

Performance

Colour Rendering	Ra>80/90
Longevity	50,000 hours
System Power	30 W 40 W 50 W
Exit Lumens	2,400 lm @4000K 3,400 lm @4000K 4,250 lm @4000K
Efficiency	85.00 lm/cW 85.00 lm/cW 85.00 lm/cW
Compliance	Building Regulations ETL (Energy Technology List) ECA (Enhanced Capital Allowance) SKA Rating

Available options

Wattage	30W - 2550 lm, 40W - 3400 lm, 50W - 4250 lm
Colour	White, Special RAL Colour
Colour Temperature	3000K, 4000K, 5000K
Beam Angle	30°, 45°, 80°
Dimming	Fixed Output, 1-10v Dimming, DALI Dimmable, Mains Dimming, Swith Dimming
Emergency	Not required, 3 Hour Facility, 3 Hour Self Test, 3 Hour Central Test, Central Battery System

Product Code: DRC-X